

Hero

LightShift™ adjustable luminaire

Ceiling recessed

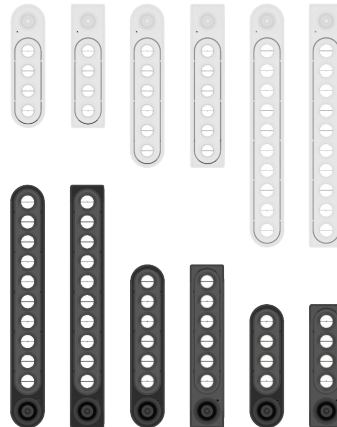

PRODUCT DESCRIPTION

Hero adjustable luminaire with LightShift technology provides for beam adjustment with a joystick-actuated internal mechanism that does not move or reorient the luminaire body. Harmonious integration into the architecture and flexible installation into the tightest spaces. Fixed light emitting face orientation, precision optics, adaptive glare baffle, and advanced anti-reflective materials provide for exceedingly low glare. Available with a wide range of beam characteristics, shapes, colors, and mounting configurations.

PERFORMANCE

Light Output	1150 lumens (3000 K)			
Efficacy	58 lumens/watt (3000 K)			
Color Temperature	2700, 3000, 3500, 4000 K			
Color Rendering	92 CRI			
Beam: Width	11°	15°	21°	34°
Field angle	20°	26°	37°	58°

ADJUSTMENT

Tilt	rated to $\pm 40^\circ$
Pan	infinite (360° with no stops)

ELECTRICAL

Operating Power	20 W, 120-277 V, 50-60 Hz, power factor > 0.9
Dimming	1% phase, 0-10 V, or DALI, 0.1% optional

MECHANICAL

Mounting	Non-IC new construction, other forms coming in 2023
Trim	trimless (mud-in), other trims coming in 2023
Shape	rectangular or rounded
Height (in plenum)	3.4" nominal
Hanger Length	14" to 24" standard, 12" to 48" optional adjustable butterfly mounts available



PHOTOMETRICS

	2700K	3000K	3500K	4000K
Lumens	1200	1260	1307	1360
CRI Ra	92	96	95	94
CRI R9	65	79	81	74
TM30 Rf	89	94	94	92
TM30 Rg	103	101	102	99
11° CBCP	27319	28685	29755	30962
15° CBCP	15614	16395	17007	17696
21° CBCP	7640	8022	8321	8659
34° CBCP	3047	3200	3319	3454

Illuminance measured for 3000K with beam direction at 0° and 30°. Cone size is marked at 50% of peak illuminance. Photometric files available for download at <https://www.glintlighting.com/resources>

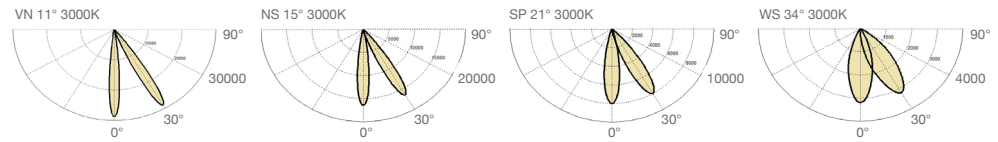

Footcandles - tilted 0°

Height (ft)	VN 11°	NS 15°	SP 21°	WS 34°
1	28685	16395	8022	3200
4	1793	1025	501	200
8	448	256	125	50
12	199	114	56	22
16	112	64	31	12
20	72	41	20	8
25	46	26	13	5
30	32	18	9	4

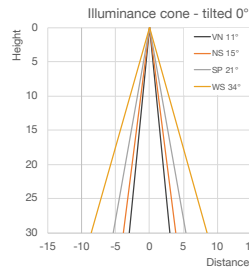

Footcandles - tilted 30°

Height (ft)	VN 11°	NS 15°	SP 21°	WS 34°
1	24842	14198	6947	2771
4	1553	887	434	173
8	388	222	109	43
12	173	99	48	19
16	97	55	27	11
20	62	35	17	7
25	40	23	11	4
30	28	16	8	3

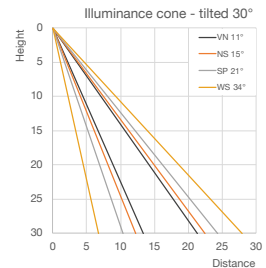

DIMENSIONS

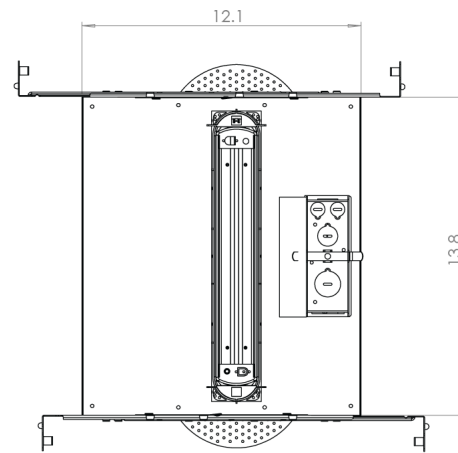
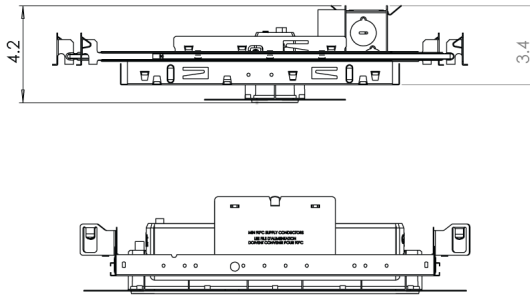

ORDERING INFORMATION

Please create order codes for your specification from the selections below. For custom requirements, please indicate X in the appropriate field and separately write out your request or contact us for a custom build or setup code.

<input type="text"/>	-	<input type="text"/>	-	<input type="text"/>	-	<input type="text"/>	-	<input type="text"/>	-	<input type="text"/>		
MODEL		SIZE		SHAPE		COLOR		INSTALLATION		TRIM		VOLTAGE
A1015 Hero non-IC		10 10 LED		R rectangular P rounded		WHT white BLK black		NSR new construction		TLM trimless mud-in		U12 120V U27 277V
-	<input type="text"/>	-	<input type="text"/>	-	<input type="text"/>	-	<input type="text"/>	-	<input type="text"/>	-	<input type="text"/>	
DIMMING		CCT / CRI Ra		BEAM SIZE		LIGHT OUTPUT		CUSTOM BUILD		CUSTOM SETUP		
E10 phase 1%		2790 2700K 92 CRI		VN 11°		SO standard		STK stock build		STD standard setup		
T10 0-10V, 1%		3090 3000K 92 CRI		NS 15°		XO custom		- - - custom		LIN linear dim curve		
TX1 0-10V, 0.1%		3590 3500K 92 CRI		SP 21°						- - - custom		
D10 DALI-2, 1%		4090 4000K 92 CRI		WS 34°								
DX1 DALI-2, 0.1%		XCT custom		XB custom								